

RECEIVED: 22/05/2023

APPENDIX 3A

CONSULTATION LETTERS AS ISSUED

Our file Ref: C216 – LT01
Your file ref:

Dated: 23rd November 2022

RECEIVED: 22/05/2023

name.,
name.,
name.,
name.,
name.,

RE: Hibernia Steel Products Limited– Proposed lodgement of planning application, and associated Environmental Impact Assessment Report and Natura Impact Assessment to construct (& operate) a hot-dip galvanising facility with zinc kettle at Mell, Drogheda, Co. Louth.

Dear Sir/Madam

1. I am writing to you in relation to a proposed planning application for Hibernia Steel Products Limited at Mell, Drogheda, Co. Louth. The company are proposing to construct (& operate) a hot-dip galvanising facility with zinc kettle.
2. The proposed development will involve the construction of a new shed, which shall process up to 35,000TPA of steel at the facility, along with all ancillary site development works.
3. Boylan Consulting have been commissioned by Hibernia Steel Products Limited, to prepare the Planning Application and associated Environmental Impact Assessment Report (EIAR) and Natura Impact Assessment (NIS) for submission to Louth County Council. The Environmental Impact Assessment Report will thoroughly address all possible environmental impacts the proposed development may have on the surrounding environment.
4. As part of the scoping process for this application we wish to inform you of the application and address any queries that you may have in relation to the proposed site activities. We therefore invite you to contact us at the below address, or alternatively we can meet with you at the subject site at a mutually convenient time.
5. Please refer to Appendix 1 of this letter for the Site Location Map.

Yours faithfully,



Niamh Murray
Environmental Scientist

Return address for public consultation feedback:

Postal: Cathal Boylan, Boylan Consulting, Main St., Mullagh, Kells, Co. Meath.

Email: n.murray@BoylanEngineering.ie

RECEIVED: 22/05/2023



RECEIVED: 22/05/2023

Appendix 1 – Site Location Map



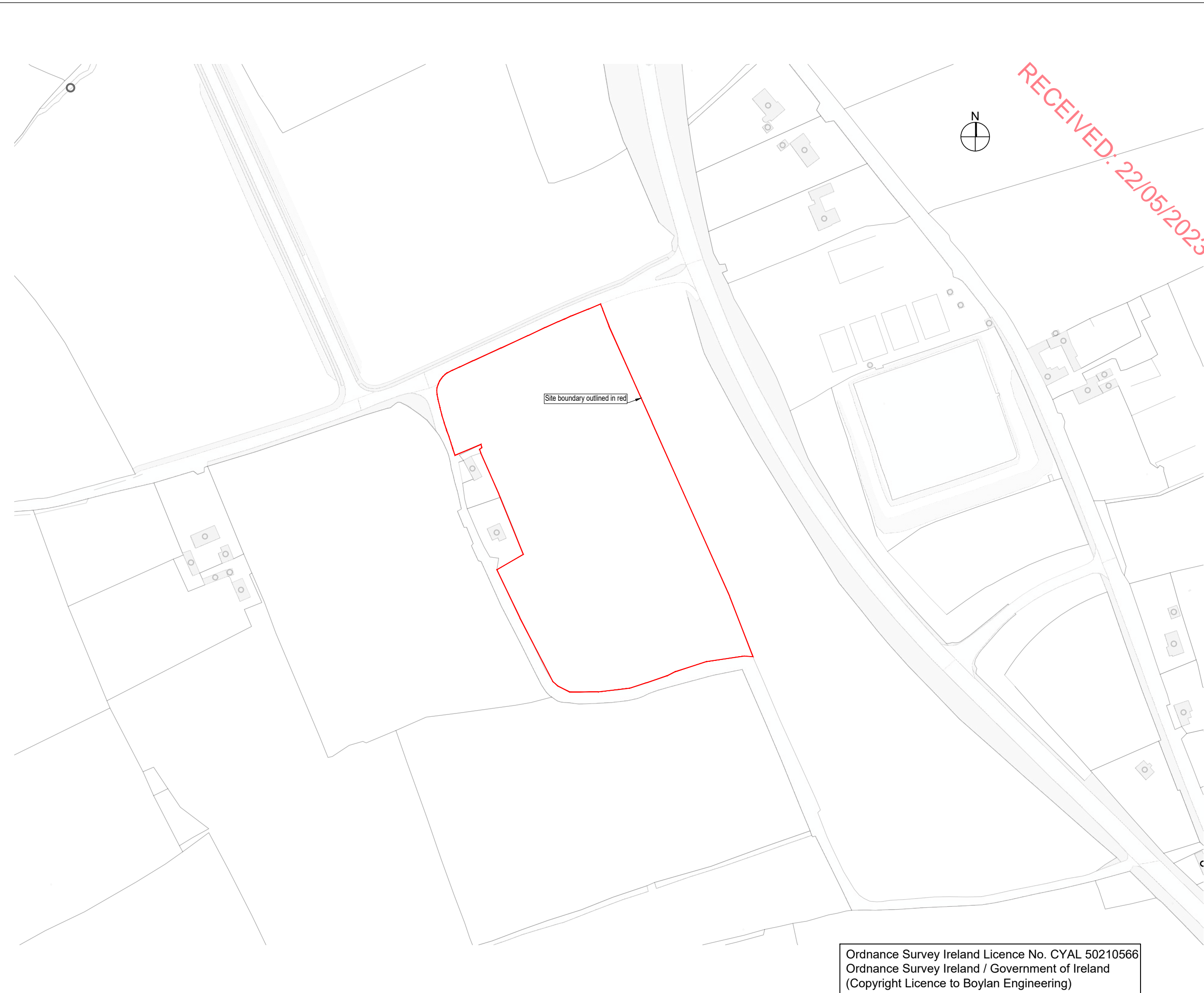

Please Note
 Do not scale from drawing.
 All dimensions should be verified on site before construction and any discrepancies found brought to the attention of the Engineer.
 All drawings remain the property of Boylan Engineering, permission must be sought to copy any drawing or section of the drawing.

NOTES / LEGEND

ITM Centre Point Co-ordinates:
 East: 706788 North: 777309

LEGEND:

——— Site Boundary

P1	30.11.22	CORRECT SITE BOUNDARY
P0	08.07.22	ISSUED TO CONSULTANTS

Client: Hibernia Steel

Project: Proposed Galvanising Plant at Mell,
 Drogheda,
 Co. Louth



Main St., Mullagh, Kells, Co. Meath.
 Phone: 046 - 928 6000
 Email: info@BoylanConsulting.ie
 Website: www.BoylanConsulting.ie

Drawn By	Approved By
A. Goncalves	C. Boylan

Drawing No.	Drawing Name
C216-DR-BCON-CE-005	Site Location Map

Date	Scale	Rev.
08/07/2022	1:2,500 @ A3	P1

Ordnance Survey Ireland Licence No. CYAL 50210566
 Ordnance Survey Ireland / Government of Ireland
 (Copyright Licence to Boylan Engineering)